

Subdivision of
RICHARDSON PLACE.

Tampa Fla.
Feb. 1915.

C.R. Knight
Civil Engineer.

Scale - 1"=50'

MAP REDUCED IN SIZE
Amk

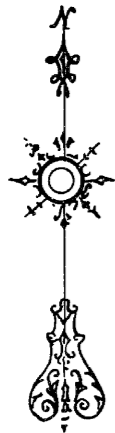
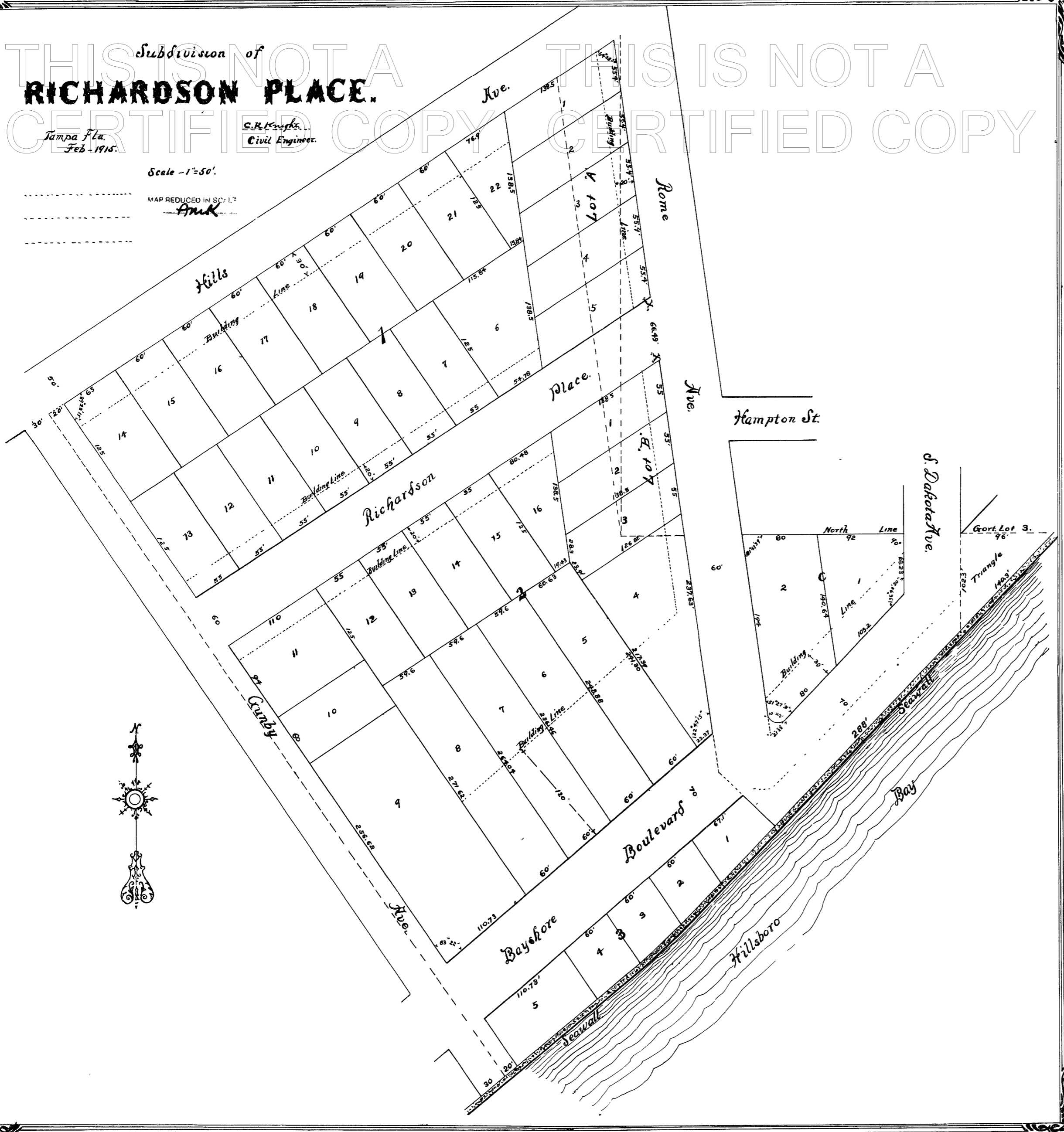

RICHARDSON PLACE.

A Subdivision of the following described tracts of land, to-wit:
Begin at the S.E. Corner of the S.E. 1/4 of the NW 1/4 of Sec. 26
T. 29 S. R. 18 E. and run N. 532.5' more or less to a 50' avenue;
thence S. 57 deg. 34' W. 744.1' more or less along said avenue
to a 30' street; thence S. 36 deg. 35' E. 772.7' more or less to
Hillsborough Bay; thence in an N.E. direction along the shore
of Hillsborough Bay to the point of intersection of Hillsborough
Bay with the S. Boundary Line of Lot 2, Sec. 26, T. 29 S. R. 18 E.;
thence W along the said S. Boundary Line of Lot 2 to the place
of beginning; said land being a part of Govt. Lot 3 and of the S.E. 1/4
of the N.W. 1/4 of Sec. 26, T. 29 S. R. 18 E. containing 10.29 acres more or less.
Also Lot 'B' of West Hyde Park Subdivision, according to plat of the
same as recorded on page 36, plat book 3, records of Hillsborough
County Florida. Also a tract of land 30' wide E & W and
extending from Hills Avenue U. & on the North to Hillsborough Bay
on the South, as is shown by map of same being dedicated by
E. J. Hills and Mary E. Hills, his wife and Peary L. Jarvis, as is
shown by the plat of same recorded in plat book 2, page 20,
records of Hillsborough County, Florida.

State of Florida } ss.
County of Hillsborough }

Know all men by these presents, that we W.C. Richardson and Mary
D. Richardson his wife, Lemuel R. Woods and Clara E. Woods his wife, and
Barbara McCluer, being the owners of all the lands embraced in the
attached subdivision, known as "RICHARDSON PLACE" do consent that the
same be placed of record in the office of the Clerk of the Circuit
Court of Hillsborough County State of Florida, and the said W.C. Rich-
ardson and his wife Mary D. Richardson do hereby dedicate, all Streets,
Avenues, Boulevards and the "Triangular tract" at the extreme eastern
terminus of Government Lot Two (2) of Section 26 Twp. 29 S. R. 18 E. as
described and set forth in said Subdivision, to the use and benefit
of the public.

In witness whereof, the said parties have hereunto set their hands
and seals this 8th day of July A.D. 1915.

In presence of
C. B. Brown

W.C. Richardson (l.s.)

Mary D. Richardson (l.s.)

Wm. P. C. Chapman

L. R. Woods (l.s.)

Clara E. Woods (l.s.)

Barbara McCluer (l.s.)

W. M. Cline

State of Florida
Hillsborough County
Before me the undersigned authority, personally appeared W.C.
Richardson, and Mary D. Richardson, his wife, Lemuel R. Woods, and Clara E.
Woods his wife, and Barbara McCluer, who are personally known to me and
acknowledge that they executed the above instrument of writing for the
uses and purposes therein mentioned, and that they did the same as their
free act and deed.

Witness my hand and official seal this 10th day of July A.D. 1915.

Notary Public
My Commission expires Jan. 22nd 1916.



State of Florida
Hillsborough County
City of Tampa.
The above Map of "Richardson Place" is accepted by the
City of Tampa, through its City Council, and authority for recordation
is granted.

Attest _____ Mayor

City _____ Clerk

Filed for Record
Nov. 13th 1915
And Record Verified
W. P. Culbreath, City Clerk.
By Frances M. Toland, D.C.

STATE OF FLORIDA
COUNTY OF HILLSBOROUGH

THIS IS TO CERTIFY THAT THIS PLAT IS A
TRUE AND CORRECT COPY THAT HAS BEEN
PHOTOGRAPHICALLY RE-CREATED FROM THE
ORIGINAL PLAT OR TRACING THEREOF
RECORDED BY THE CLERK OF THE COUNTY OF
HILLSBOROUGH COUNTY, FLORIDA.

RECORD VERIFIED

WITNESS MY HAND AND OFFICIAL SEAL THIS
10 DAY OF July 1915

RICHARD AKE, CLERK
Richard Ake

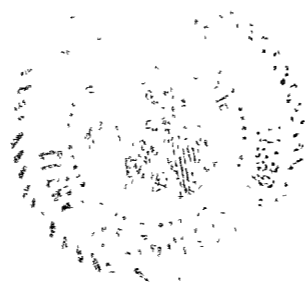

Book 1 pg 140

RESOLUTION FILED

DATE: 10-11-93

OR BK 7148 PG 946

By: Beadie S. Burnett
DEPUTY CLERK